

KI27

IP65

**KOLLU PANO KİLİDİ 27
SWING HANDLE 27**

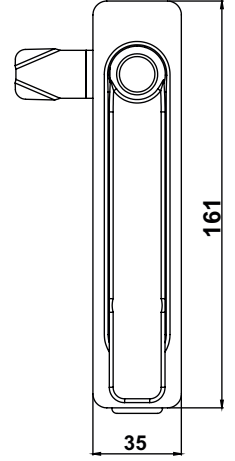
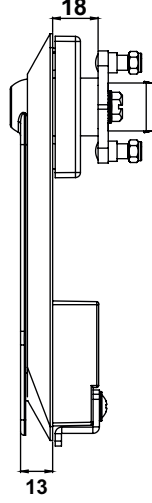
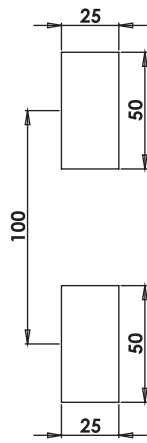

Geçiş Ölçüsü
Cut Out

KI29

IP65

**KOLLU PANO KİLİDİ 29 (Asma Kilit Hamilli)
SWING HANDLE 29 (For Padlock)**

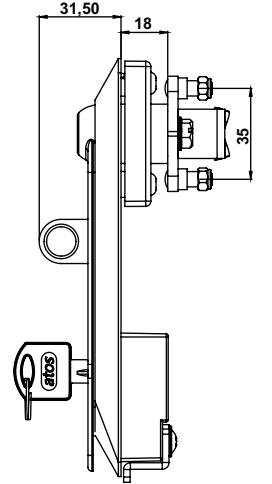
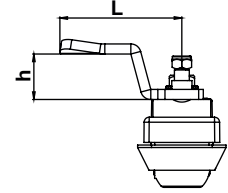

Kullanım Alanları

- * Elektrik Panoları
- * Makina Kapakları
- * Bilgisayar Kabinleri

Malzeme

- * Gövde: Polyamide
DIN-EN ISO 1043-1 PA6 GFR30
- * Kol : Polyamide
DIN-EN ISO 1043-1 PA6 GFR30
- * Dil (CC):Çelik veya Plastik /
- * Conta : PVC
- * Asma Kilit Hamili : Zamak
DIN-EN 1774-ZnAl4Cu1

Applications

- * Electric Panels
- * Machinery Covers
- * Rack Cabinets

Material

- * Body: Polyamide
DIN-EN ISO 1043-1 PA6 GFR30
- * Handle: Polyamide
DIN-EN ISO 1043-1 PA6 GFR30
- * Cam (CC): Steel or PA6
- * Seal: PVC
- * Padlock :Zamak
DIN-EN 1774-ZnAl4Cu1



Grup Kodu	Fişe-Göbek Kodu	Dil Kodu
Group Code	Cylinder-Driver Code	Cam Code
KI27	.00 / .DD	.CC
KI29	Fişeler - Göbekler için Sayfa: 2 - Tablo: A/B For cylinders - drivers please check Page: 2 - Table: A/B	Diller için Sayfa:1 - Tablo: 1 /2 /3 For cams please check Page:1 - Table: 1 /2 /3
	.00: Fişesiz / Without Cylinder	